

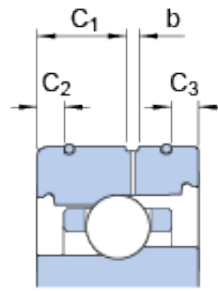

NTN PRECISION AXLE CORP.

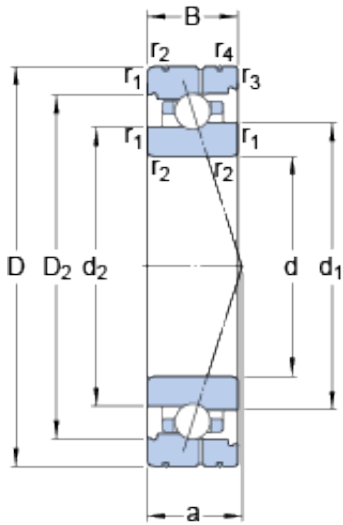

50 mm x 72 mm x 12 mm SKF 71910
ACB/HCP4AL angular contact ball bearings

Bearing No. 71910 ACB/HCP4AL

71910 ACB/HCP4AL Bearing 2D drawings and 3D CAD models

Size	72x50x12 mm
Bore Diameter	72 mm
Outer Diameter	50 mm
Width	12 mm
d	50 mm
D	72 mm
B	12 mm
d ₁	57.95 mm
d ₂	56.9 mm
D ₂	66.04 mm
b	2 mm
C ₁	5.9 mm
C ₂	2.8 mm
C ₃	1.7 mm
r _{1,2} - min.	0.6 mm
r _{3,4} - min.	0.3 mm
a	23.2 mm
d _a - min.	53.2 mm
d _b - min.	53.2 mm
D _a - max.	68.8 mm
D _b - max.	70 mm
r _a - max.	0.6 mm
r _b - max.	0.3 mm
d _n	58.7 mm



NTN PRECISION AXLE CORP.

Basic dynamic load rating - C	7.3 kN
Basic static load rating - C ₀	5.8 kN
Fatigue load limit - P _u	0.25 kN
Limiting speed for grease lubrication	28000 r/min
Limiting speed for oil lubrication	43000 mm/min
Ball - D _w	4.762 mm
Ball - z	29
G _{ref}	1.89 cm ³
Calculation factor - e	0.68
Calculation factor - Y ₂	0.87
Calculation factor - Y ₀	0.38
Calculation factor - X ₂	0.41
Calculation factor - Y ₁	0.92
Calculation factor - Y ₂	1.41
Calculation factor - Y ₀	0.76
Calculation factor - X ₂	0.67
Preload class A - G _A	43 N
Preload class B - G _B	86 N
Preload class C - G _C	260 N
Calculation factor - f	1.09
Calculation factor - f ₁	0.99
Calculation factor - f _{2A}	1
Calculation factor - f _{2B}	1.02
Calculation factor - f _{2C}	1.08
Calculation factor - f _{HC}	1.01
Preload class A	89 N/micron
Preload class B	114 N/micron



NTN PRECISION AXLE CORP.

Preload class C	172 N/micron
d_1	57.95 mm
d_2	56.9 mm
D_2	66.04 mm
C_1	5.9 mm
C_2	2.8 mm
C_3	1.7 mm
$r_{1,2}$ min.	0.6 mm
$r_{3,4}$ min.	0.3 mm
d_a min.	53.2 mm
d_b min.	53.2 mm
D_a max.	68.8 mm
D_b max.	70 mm
r_a max.	0.6 mm
r_b max.	0.3 mm
d_n	58.7 mm
Basic dynamic load rating C	9.75 kN
Basic static load rating C_0	9.65 kN
Fatigue load limit P_u	0.25 kN
Attainable speed for grease lubrication	28000 r/min
Attainable speed for oil-air lubrication	43000 r/min
Ball diameter D_w	4.762 mm
Number of balls z	29
Reference grease quantity G_{ref}	1.89 cm ³
Preload class A G_A	43 N
Static axial stiffness, preload class A	89 N/ μ m
Preload class B G_B	86 N
Static axial stiffness, preload class B	114 N/ μ m
Preload class C G_C	260 N



NTN PRECISION AXLE CORP.

Static axial stiffness, preload class C	172 N/ μ m
Calculation factor f	1.09
Calculation factor f_1	0.99
Calculation factor f_{2A}	1
Calculation factor f_{2B}	1.02
Calculation factor f_{2C}	1.08
Calculation factor f_{HC}	1.01
Calculation factor e	0.68
Calculation factor (single, tandem) Y_2	0.87
Calculation factor (single, tandem) Y_0	0.38
Calculation factor (single, tandem) X_2	0.41
Calculation factor (back-to-back, face-to-face) Y_1	0.92
Calculation factor (back-to-back, face-to-face) Y_2	1.41
Calculation factor (back-to-back, face-to-face) Y_0	0.76
Calculation factor (back-to-back, face-to-face) X_2	0.67
Mass bearing	0.13 kg